

**interpack**

PROCESSES AND PACKAGING  
DOSSELDORF, GERMANY, 24-30 APRIL 2008

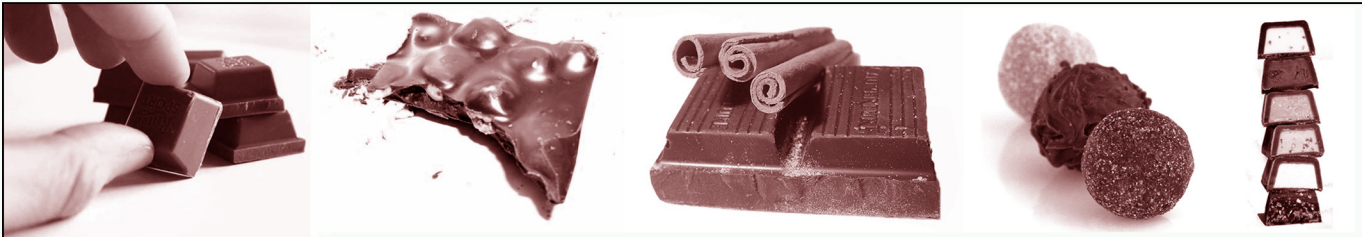

 messedesign





**rückblick**

# IPACK-IMA MILANO FEB. 2006

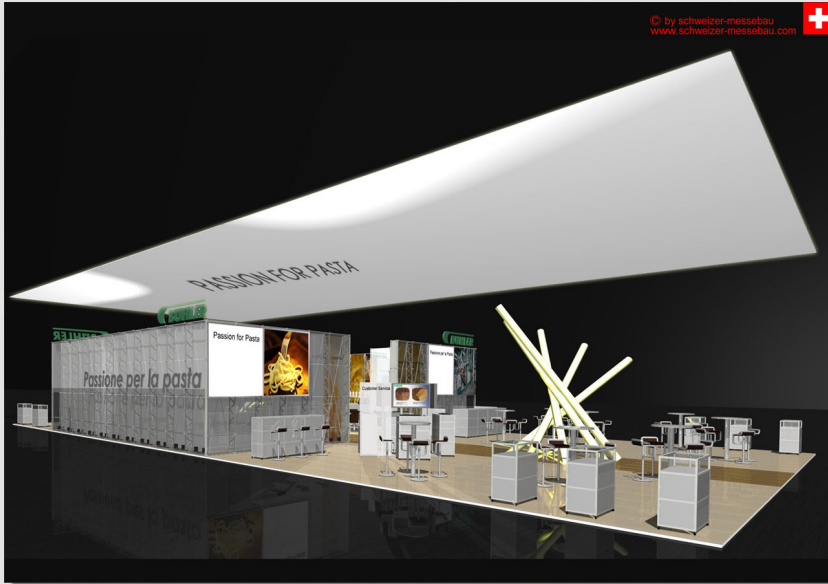

# IBA MÜNCHEN OKT. 2006

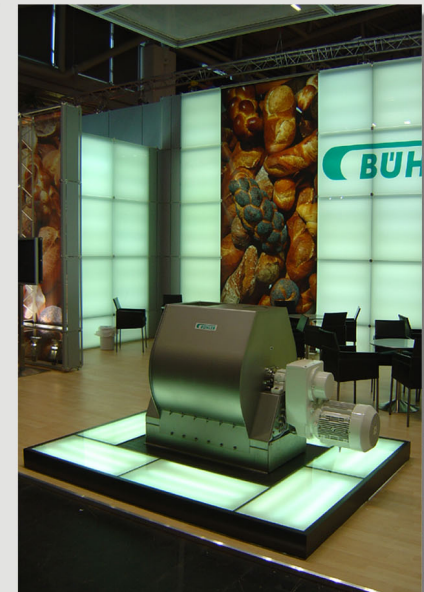
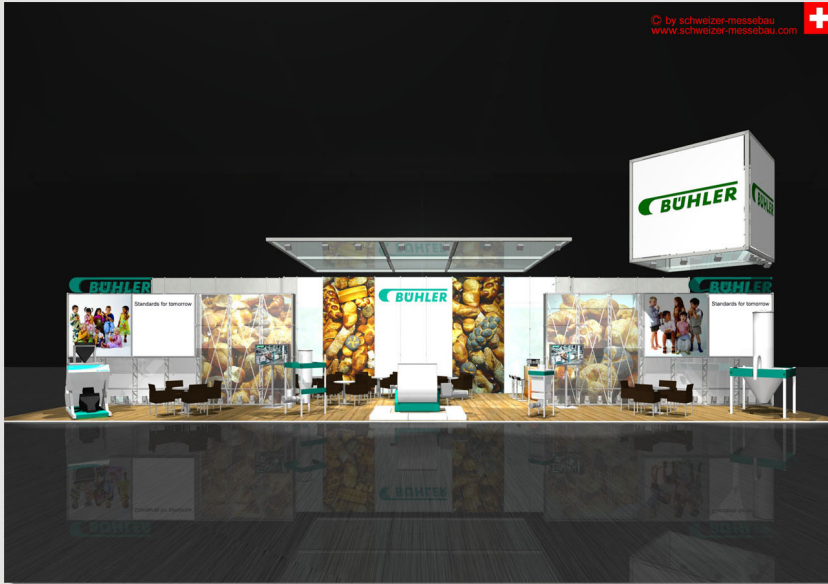

# victam utrecht mai 2007

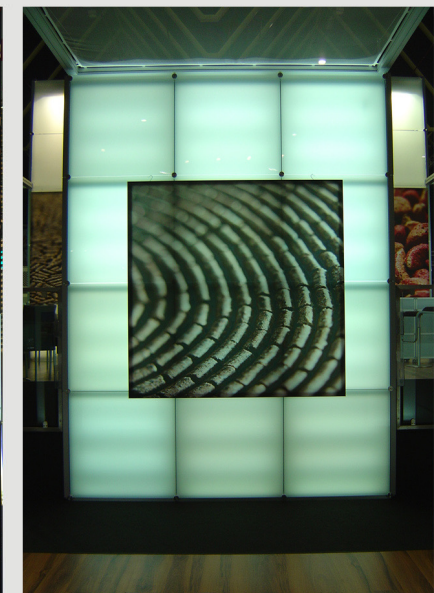
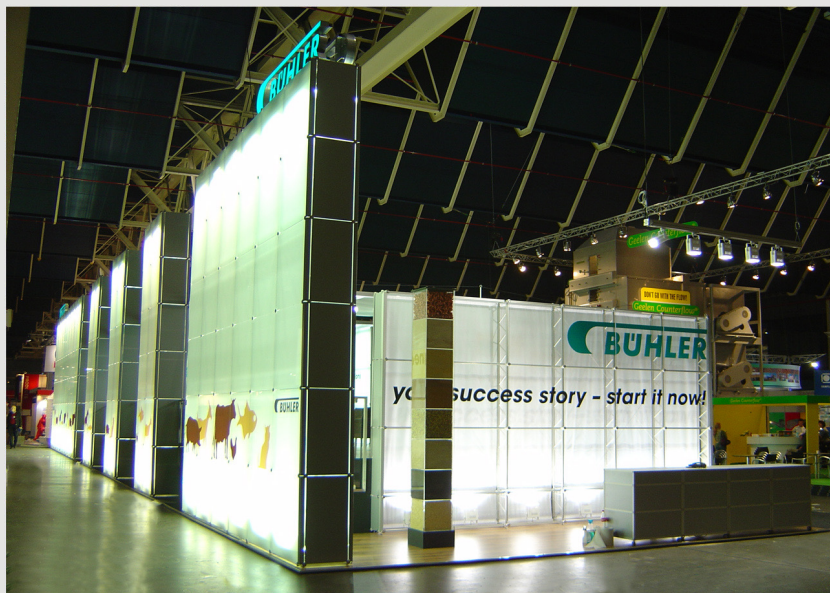



**konzept**

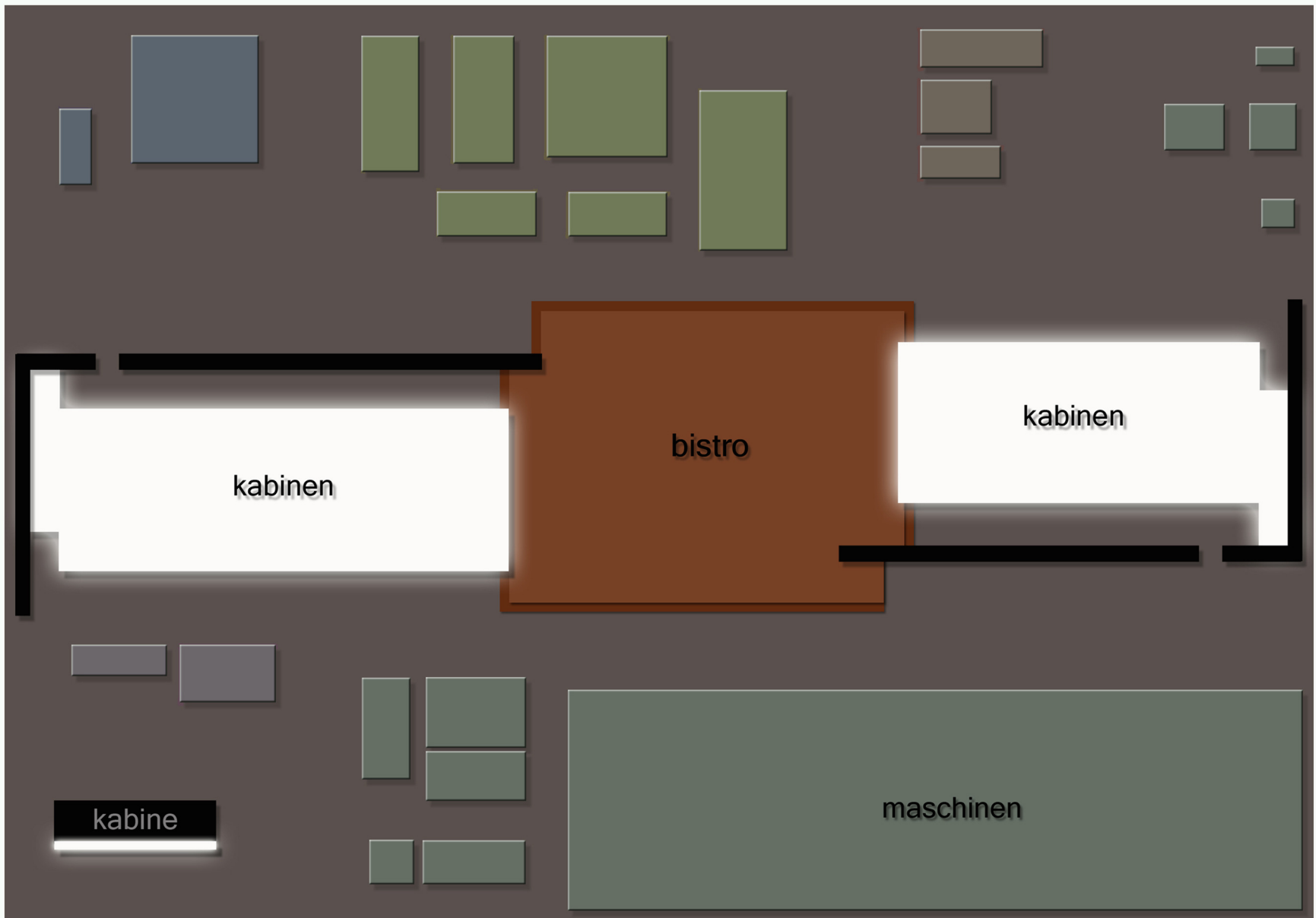



grafiken



menschen



cacao plantage



cacao



cacao plantage panorama



schokolade





**fernsicht**

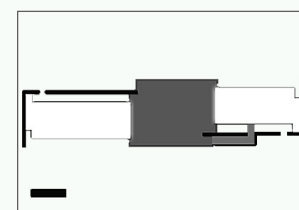
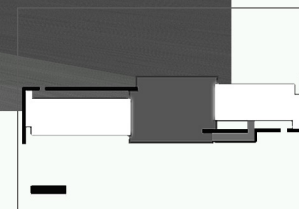
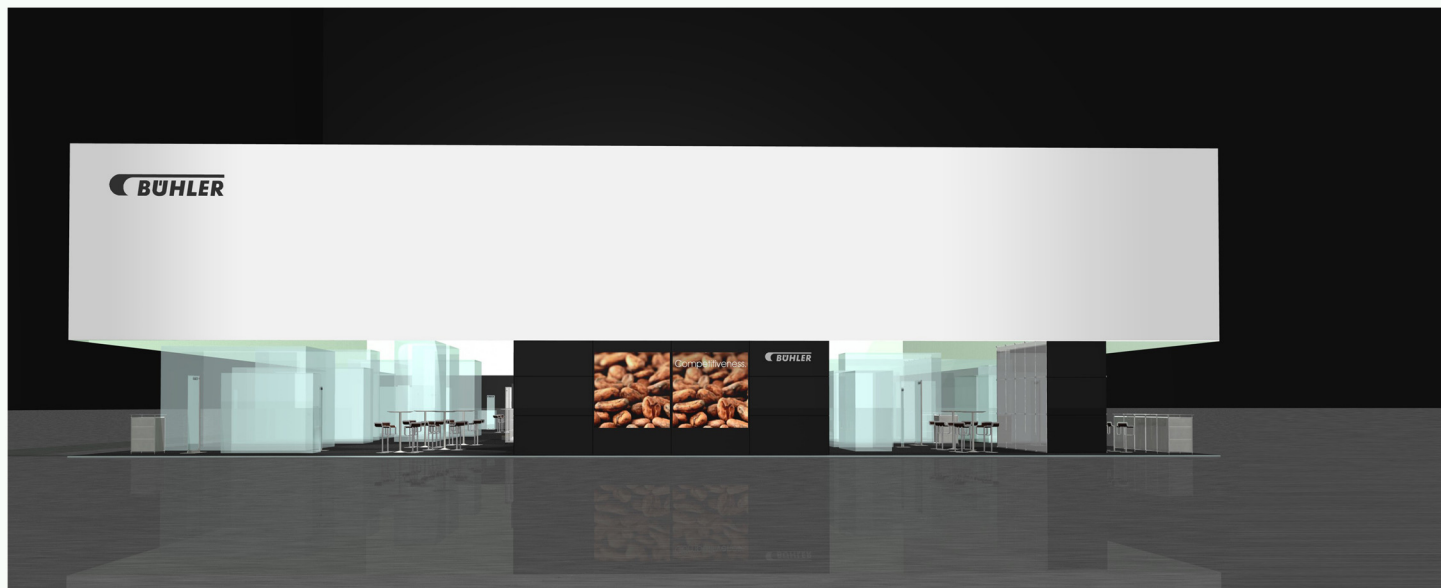
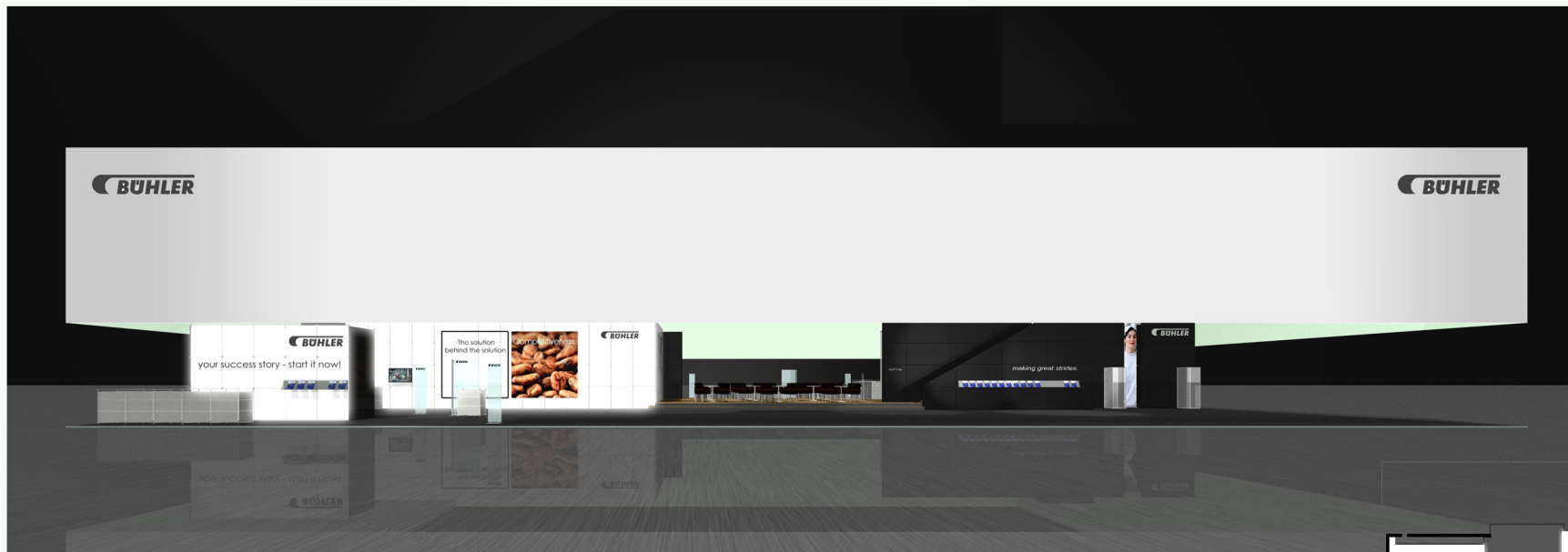

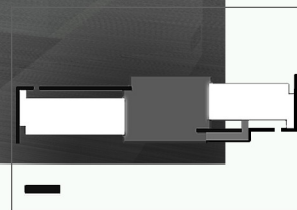
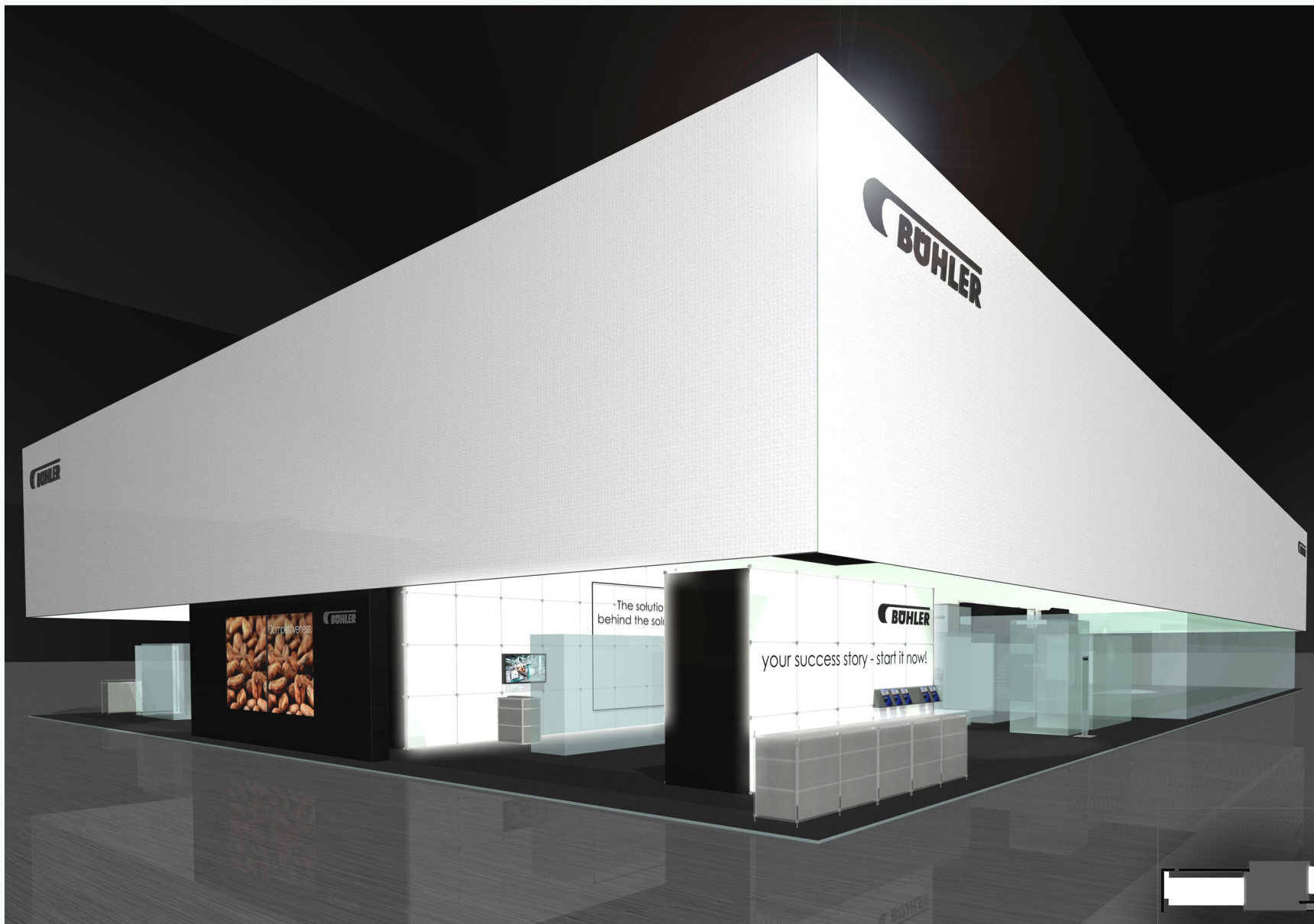



fassaden





The solution  
The solution  
behind the solution



**BÜHLER**

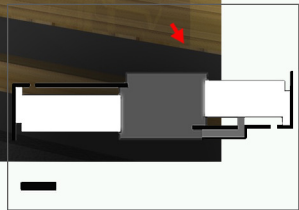

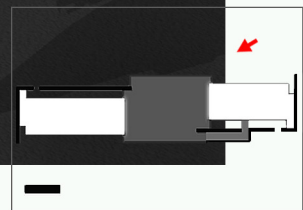

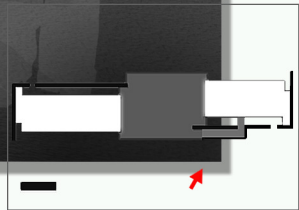
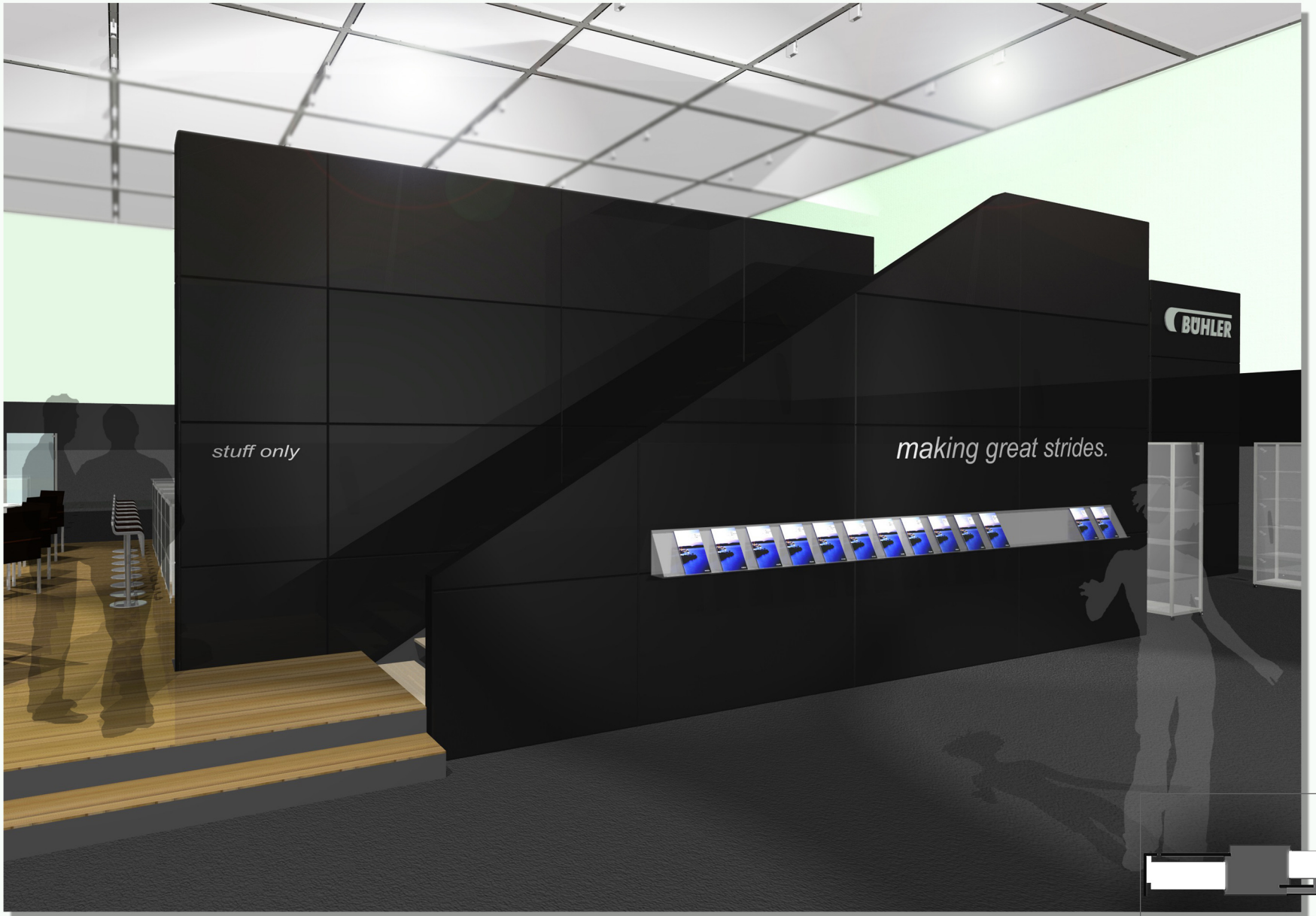



obergeschoss

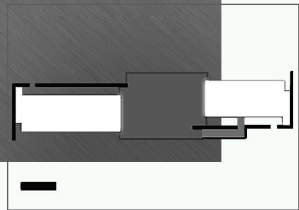





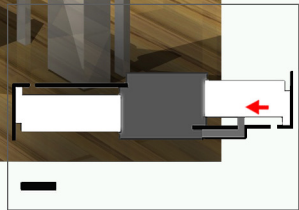



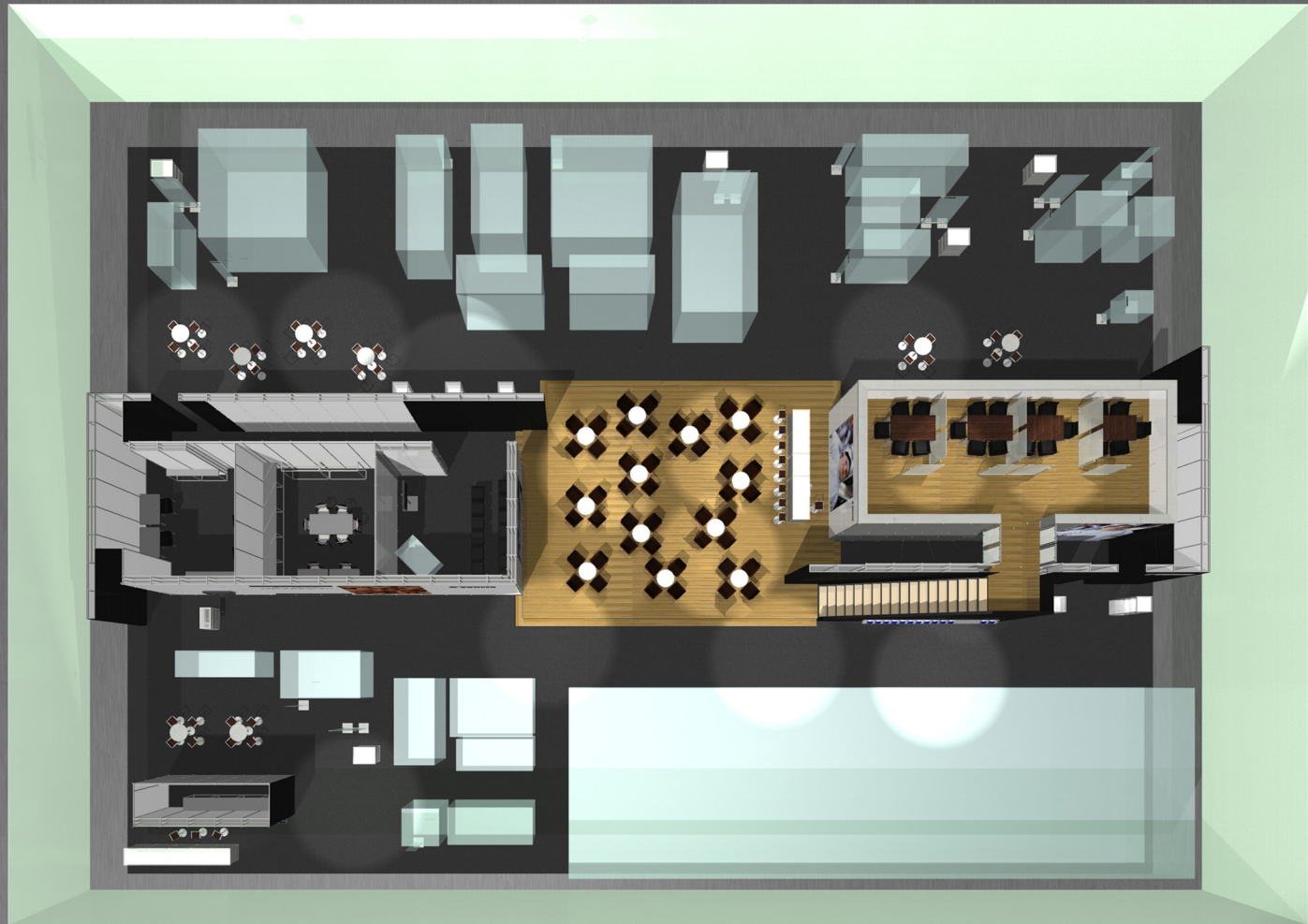



produkte  
identifikation



beschriftung maschinen / maschinengruppen

